



**COURTYARD**<sup>®</sup>  
BY MARRIOTT

Paris Gare de Lyon

LIVE  
YOUR  
PASSION

  
209-211 Rue de Bercy  
75012 PARIS



# A CITY, A HOTEL: A SHARED PERSONALITY

ITS PERSONALITY IS FIRMLY ROOTED IN THAT OF THE CITY, WITH ITS CLEAN INTERIOR DESIGN AND BREATH-TAKING VIEW FROM THE BUILDING'S 60-METER SUMMIT.



19  
FLOORS



249  
ROOMS



360°  
VIEW



9 MEETING ROOMS  
ON 250 M<sup>2</sup>

*Campus Créatif*  
WORK HARD PLAY HARD

CREATIVE CAMPUS



STARBUCKS



FITNESS  
24/24



GRAB AND  
GO 24/24



92 PARKING  
SPOTS



CHARGING  
STATIONS



# IN THE HEART OF THE 12<sup>TH</sup>

# A TRANSPORT HUB

A UNIQUE MIX BETWEEN THE PARISIAN CHARM AND ITS HISTORICALLY INDUSTRIAL NATURE

- A dynamic district that appeals to both savvy travellers and millennials.
- The must-see sites of the Bastille, Notre-Dame de Paris and the Marais are all within walking distance.

- Metro, RER and Regional Train Stations; Easy Access to CDG and ORLY Airports
- Direct train to Disneyland Paris
- TGV for Eastern and Southern France, Switzerland, Germany, Italy and Spain

# OUR ROOMS

THE NEW CLASSIC  
SMART & SIMPLE

Find yourself perched  
between the sky & the ground  
and enjoy the most beautiful  
postcard view of the capital!

[MORE +](#)





## ROOM CHARACTERISTICS

- 21-23M<sup>2</sup> KING & TWIN
- 25-27M<sup>2</sup> FAMILY ROOMS
- HYPNOTISING VIEW OVER ALL PARISIAN MONUMENTS
- CONNECTING ROOMS
- FAMILY ROOMS
- LARGE WINDOWS

## ROOM EQUIPMENTS



ROOMS UP TO 4 PEOPLE



KING OR TWIN BEDS



SMART TV OF 121 CM



SAFE IN EVERY ROOM



WELCOME TRAY WITH COFFEE AND TEA



MINI FRIDGE IN EVERY ROOM





**K&B**



**KITCHEN & BAR**  
AT COURTYARD

ARTISANAL CUISINE — LONG DRINK ATELIER — URBAN DESIGN



ARTISANAL CUISINE  
LONG DRINK ATELIER  
URBAN DESIGN

AT  
COURTYARD®

# SIGNATURE CUISINE & LONG DRINK ATELIER



Chef Melissa Ravel brings her personal, feminine touch to the 100% gourmet bistro cuisine. She has chosen to work with a small menu based exclusively on seasonal products to give pride of place to small producers and showcase the diversity of France's terroirs

The bar shakes things up as well, thanks to a team of passionate bartenders and an innovative menu. Gin makes the top of the list, including several varieties infused with herbs from the hotel garden. This is followed by long drinks and selected wines carefully chosen from independent winegrowers.

MEETINGS  
SEMINARS

# *Creative Campus*

WORK HARD / PLAY HARD







# Creative Campus

WORK HARD PLAY HARD

## A NETWORKING HUB

- 500M<sup>2</sup> SHARED BETWEEN COFFEE BREAK AREAS AND HIGH-TECH MEETING ROOMS
- NEW, MODERN CONCEPT AND DESIGN
- FUN GAMES (POOL TABLE, CONNECT 4, RETRO VIDEO GAMES)
- DELICIOUS BISTRONOMIC MEALS CREATED BY OUR HEAD CHEF MELISSA RAVEL

### MEETING FROM 2 TO 100 PEOPLE THANKS TO :

- QUAI 5+6 : LARGE PLENARY ROOM OF 100M<sup>2</sup> - HIGH-TECH AND VERY BRIGHT.
- UP TO 7 BREAKOUT ROOMS (FROM 4 TO 30 PEOPLE)
- INCLUDING 2 BOOTHS (SMALL ROOMS FOR UP TO 4 PEOPLE)



MORE +

# OUR MEETING OFFERS

## THE DAILY DELEGATE RATE OF THE CREATIVE CAMPUS INCLUDES:

- ALL DAY COFFEE BREAKS (SWEET AND SAVOURY)
- A "BISTRONOMIC" LUNCH OF YOUR CHOICE: FINGER BUFFET, 3 COURSE OR FAMILY STYLE
- FOYER AND RECREATIONAL AREA IN DAYLIGHT
- THE MEETING ROOM RENTAL IS ADAPTED TO THE NUMBER OF THE PARTICIPANTS
- HIGH-TECH EQUIPMENT INCLUDED (SPIDER TELEPHONE, VIDEO-PROJECTION, SAMSUNG FLIPCHART, WIRELESS MICROPHONE AND SOUND SYSTEM)
- MINERAL WATER, CANDY BAR, NOTEBOOK AND PENS IN THE MEETING ROOMS

## TO BOOST THE AMBIENCE OF YOUR EVENT:



**HAPPINESS MANAGER**  
TO ANIMATE THE  
COFFEE BREAKS AND  
LUNCHES



**VINYLES MENU:**  
WELCOME YOUR  
GUESTS WITH THEIR  
FAVOURITE BAND



**RETRO VIDEO**  
GAME AT DISPOSAL  
(SUPERNES &  
MEGADRIVE)



**LIVE**  
SINGER –  
GUITARIST

## PRICING:

- DAILY DELEGATE RATE WITH  
« **FINGER BUFFET** » LUNCH  
129€ INCLUDING VAT  
(116€ EXCLUDING VAT) / PERSON





- DAILY DELEGATE RATE WITH  
« **3 COURSE** » LUNCH  
139€ INCLUDING VAT  
(125€ EXCLUDING VAT) / PERSON

- DAILY DELEGATE RATE WITH  
« **FAMILY STYLE** » LUNCH  
135€ INCLUDING VAT  
(122€ EXCLUDING VAT) / PERSON



# FLOOR PLAN & CAPACITY CHART



MEETING ROOM	 THEATER	 CLASSROOM	 U-SHAPE	 BOARD	 ROUND TABLES	MEETING ROOM SIZE
STATION 1	-	-	-	3	-	11 M <sup>2</sup>
STATION 2	-	-	-	5	-	9 M <sup>2</sup>
QUAI 1	-	-	-	11	-	27 M <sup>2</sup>
QUAI 2	-	-	-	9	-	20 M <sup>2</sup>
QUAI 3	25	12	14	14	6	31 M <sup>2</sup>
QUAI 4	25	12	14	14	6	28 M <sup>2</sup>
QUAI 5	40	24	20	20	18 (3 X 6)	44 M <sup>2</sup>
QUAI 6	50	24	20	20	24 (4 X 6)	57 M <sup>2</sup>
QUAI 3 + QUAI 4	50	25	30	30	28 (4 X 7)	59 M <sup>2</sup>
QUAI 5 + QUAI 6	100	50	40	24	56 (8 X 7)	101 M <sup>2</sup>

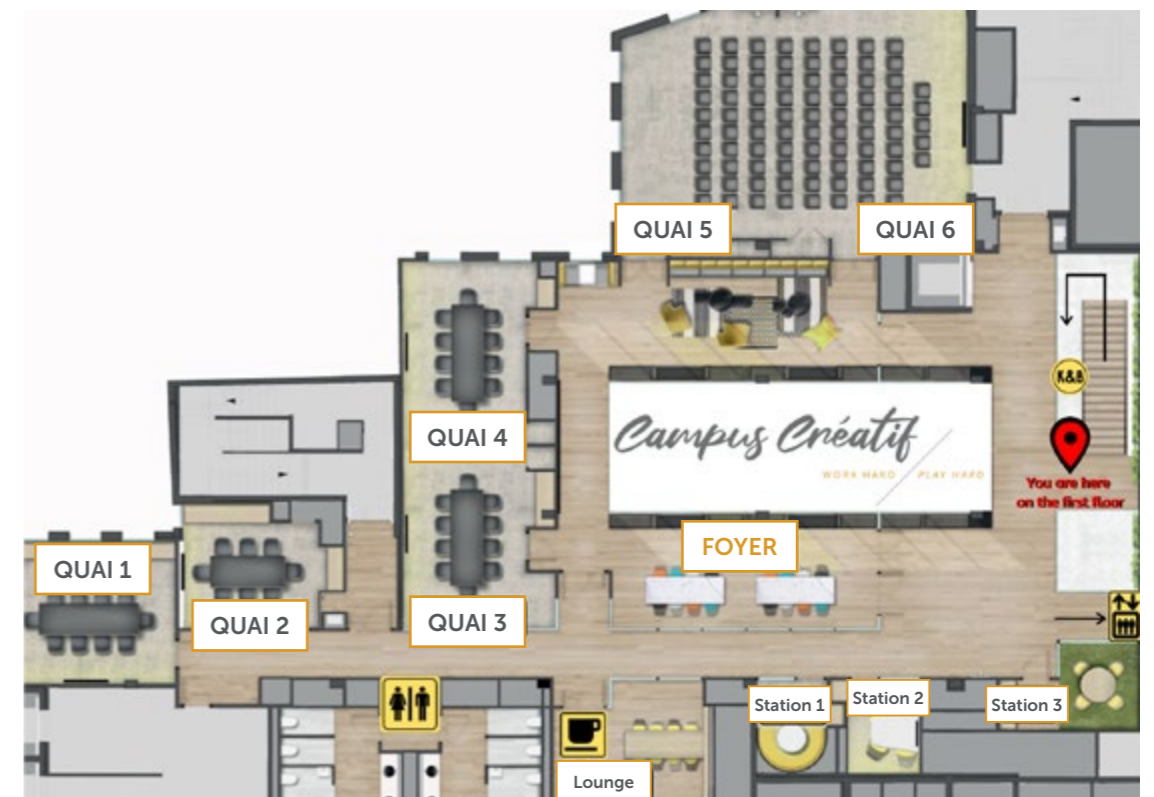



# UNWIND & REWIND

BENEFITING FROM A SOLID EXPERTISE IN BUSINESS TRAVEL, COURTYARD BY MARRIOTT MULTIPLIES THE SENSE OF DETAILS AND ARRANGEMENTS THAT MAKE THE DIFFERENCE: IN TERMS OF DESIGN AND WORK COMFORT, IN TERMS OF ENERGY IN PUBLIC SPACES AND ROOMS.

The Courtyard Paris Gare de Lyon has been designed to meet the needs of all clients.

Start the day with a workout in our fitness room to soothe your body and mind, playing the various retro games offered by the hotel during coffee breaks and at the end of the day, nothing better than having a drink and playing pool.

The hotel also offers a happiness manager who organises team-building activities throughout the day.

**MAKE THE MOST OF YOUR STAY!**

**COURTYARD**<sup>®</sup>  
BY MARRIOTT

Paris Gare de Lyon

*Follow us*  
on social media



#cyparisgdl

THE HOTEL

